

SEE DETAIL FOR "A"

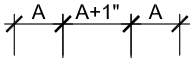

HEM PROFILE

REFER TO SMACNA OR NRCA FOR DIMENSIONS OF HEMS

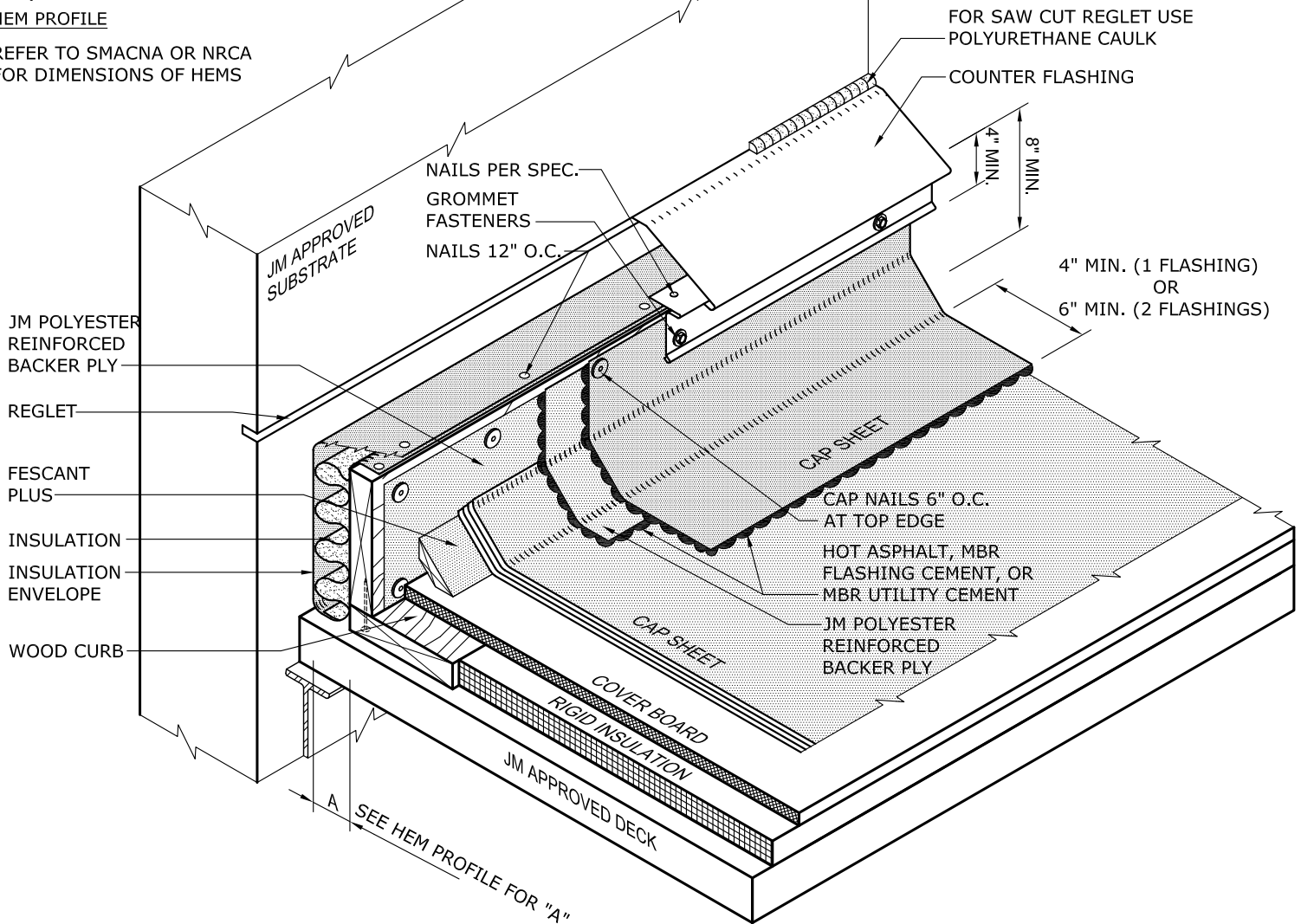

NOTES:

1. REFER TO JOHNS MANVILLE WEBSITE (www.jm.com) FOR MOST UP-TO-DATE INFORMATION.
2. JM POLYESTER REINFORCED BACKER PLY INCLUDES DYNABASE OR DYNALASTIC 180 S.
3. SHOP FABRICATED METAL EXPANSION JOINT SHOULD BE INSTALLED IN ACCORDANCE WITH SMACNA OR NRCA. LAPS SHALL UTILIZE EITHER APPROVED SPLICE PLATES OR 4" MINIMUM OVERLAPS WITH APPROVED SEALANT.
4. ANY CARPENTRY, METAL WORK, OR MASONRY CONSTRUCTION SHOULD BE DESIGNED AND CONSTRUCTED IN ACCORDANCE WITH LOCAL CODE REQUIREMENTS AND/OR PROJECT SPECIFICATIONS. THESE COMPONENTS SHOULD BE REVIEWED AND APPROVED BY A LICENSED DESIGN PROFESSIONAL.
5. VERTICAL JOINTS ARE TO BE OVERLAPPED 4" MINIMUM FOR ALL APPLICATIONS. 3 COURSING WITH MBR UTILITY CEMENT AND FABRIC OR JM MBR FLASHING CEMENT IS RECOMMENDED ON ALL VERTICAL FLASHING LAPS AND INSIDE/OUTSIDE CORNERS EXTENDING PAST LEADING EDGE OF CANT STRIP.
6. PLEASE SEE BITUMINOUS FLASHING SPECIFICATIONS FOR A FULL DESCRIPTION OF INSTALLATION INSTRUCTIONS AND REQUIREMENTS WHICH ARE CONSIDERED A PART OF THIS DETAIL.
7. THE VERTICAL WOOD CURB SHOULD BE FASTENED TO THE DECK ONLY.
8. MASONRY SUBSTRATES REQUIRE PRIMING WITH ASPHALT PRIMER PRIOR TO BACKER PLY INSTALLATION. WOOD SUBSTRATES REQUIRE A MECHANICALLY FASTENED BACKER PLY FASTENED 9" O.C. IN BOTH DIRECTIONS.

DRAWING NO.

BIT-5

EXPANSION JOINTS

BASE FLASHING FOR NON LOAD BEARING WALL - METAL E.J. (ALTERNATE)

MEMBRANE TYPE:
BUR

MAXIMUM GUARANTEE TERM:

SCALE

N.T.S

ISSUE DATE

02-06-19

Johns Manville is a manufacturer of commercial roofing products and offers this general conceptual information to you as a courtesy. This complimentary assistance is not to be used or relied upon by anyone as a substitute for professional engineering design and documentation required by building code, contract, or applicable law. By accepting these comments you agree they do not constitute any representations, endorsements of, or an assumption by Johns Manville of any liability for either the adequacy of the design of this building or any other material not supplied by Johns Manville.

