

ISOMETRIC VIEW

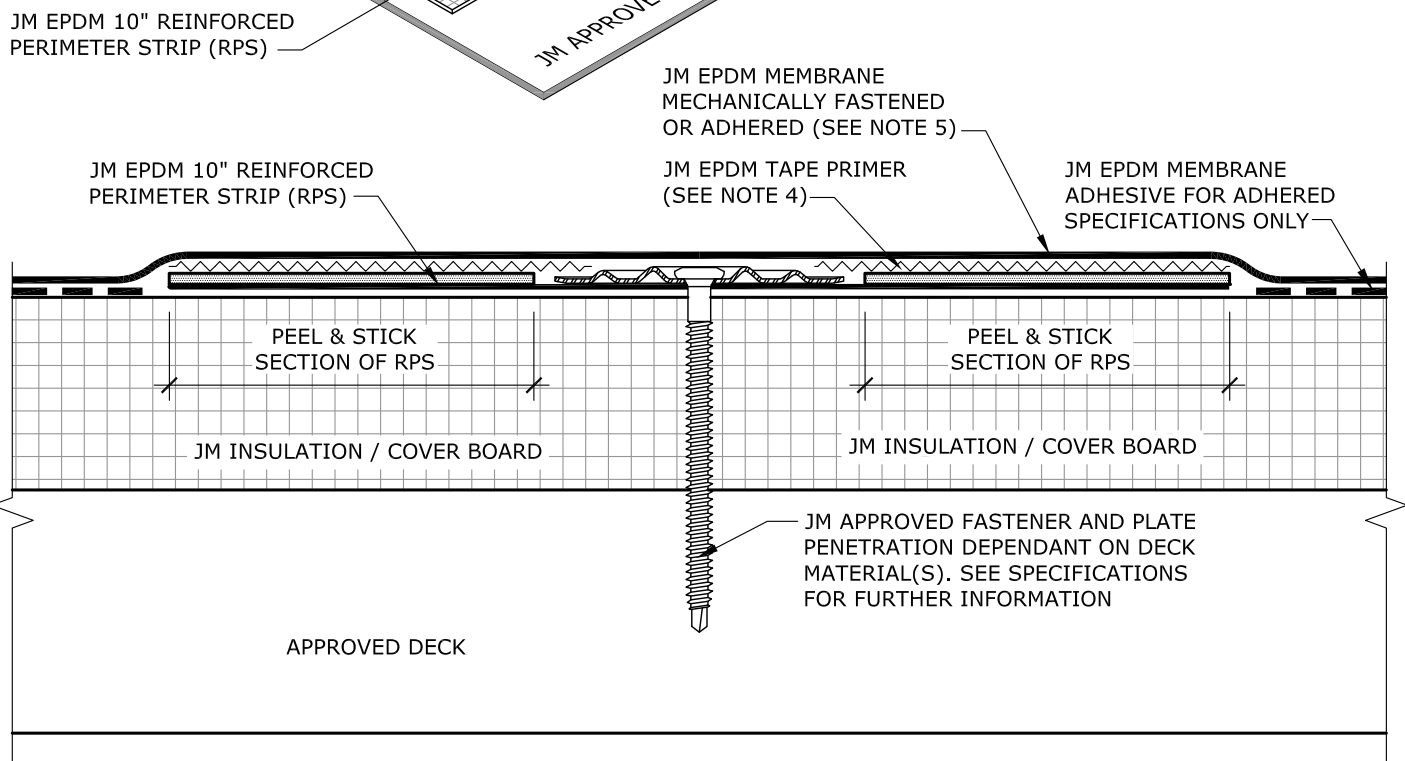

NOTES:

1. REFER TO JOHNS MANVILLE WEBSITE (www.jm.com) FOR THE MOST CURRENT INFORMATION.
2. REFER TO SINGLE PLY FLASHING SPECIFICATIONS FOR INSTALLATION INSTRUCTIONS AND REQUIREMENTS WHICH ARE PART OF THIS DETAIL.
3. ANY CARPENTRY, METAL WORK, OR MASONRY CONSTRUCTION SHOULD BE DESIGNED AND CONSTRUCTED IN ACCORDANCE WITH LOCAL CODE REQUIREMENTS AND/OR PROJECT SPECS. THESE COMPONENTS SHOULD BE REVIEWED AND APPROVED BY A LICENSED DESIGN PROFESSIONAL.
4. JM EPDM TAPE PRIMER OR JM SINGLE PLY MEMBRANE PRIMER (LOW VOC) MUST BE APPLIED TO THE UNDERSIDE OF THE JM EPDM FIELD MEMBRANE COMING INTO CONTACT WITH JM EPDM PEEL & STICK PRODUCTS. ROLL MEMBRANE WITH HAND ROLLER UNDER PRESSURE OVER ENTIRE TAPE AREA.
5. REINFORCED JM EPDM MEMBRANE IS REQUIRED FOR MECHANICALLY FASTENED INSTALLATIONS.

DRAWING NO. E-MS-21		JM REINFORCED PERIMETER STRIP (RPS) FASTENING METHOD		Johns Manville is a manufacturer of commercial roofing products and offers this general conceptual information to you as a courtesy for general educational purposes only. This complimentary assistance is not to be either used or relied upon by anyone as a substitute for professional engineering design and documentation required by any building code, contract, or applicable law. By accepting the general conceptual information, you agree it does not constitute any representations, endorsements of, or an assumption by Johns Manville of any duty or liability for either the adequacy of the design of a building, any of its components or the sufficiency of any construction.	
MEMBRANE SEAMING		MEMBRANE TYPE: JM EPDM			
SCALE N.T.S	ISSUE DATE 01-30-25	MAXIMUM GUARANTEE TERM: 30 YEAR			