

STEP 1

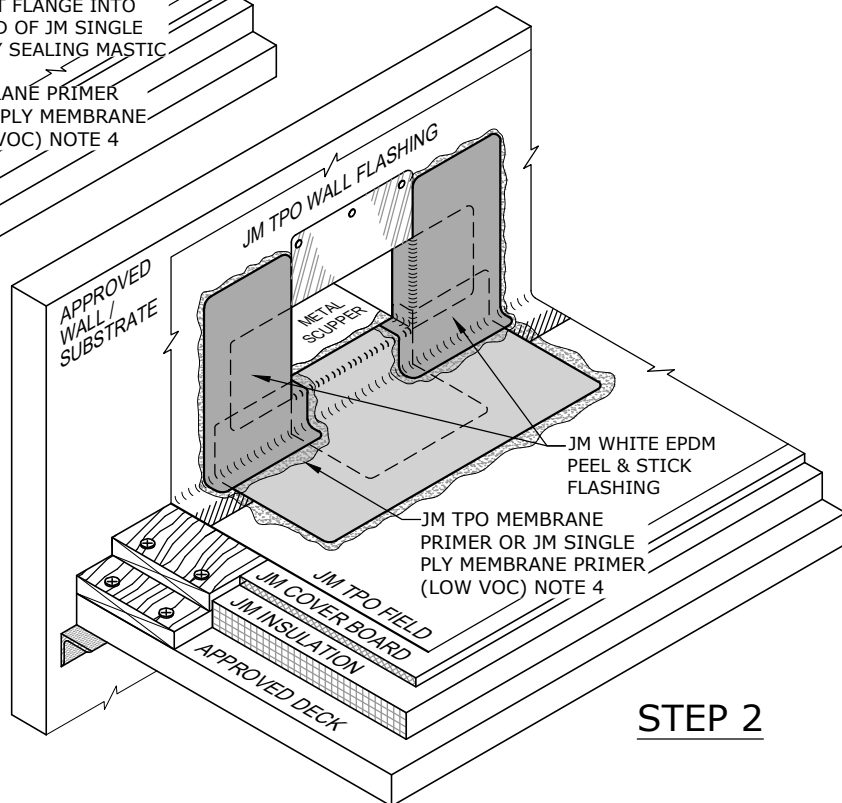

STEP 2

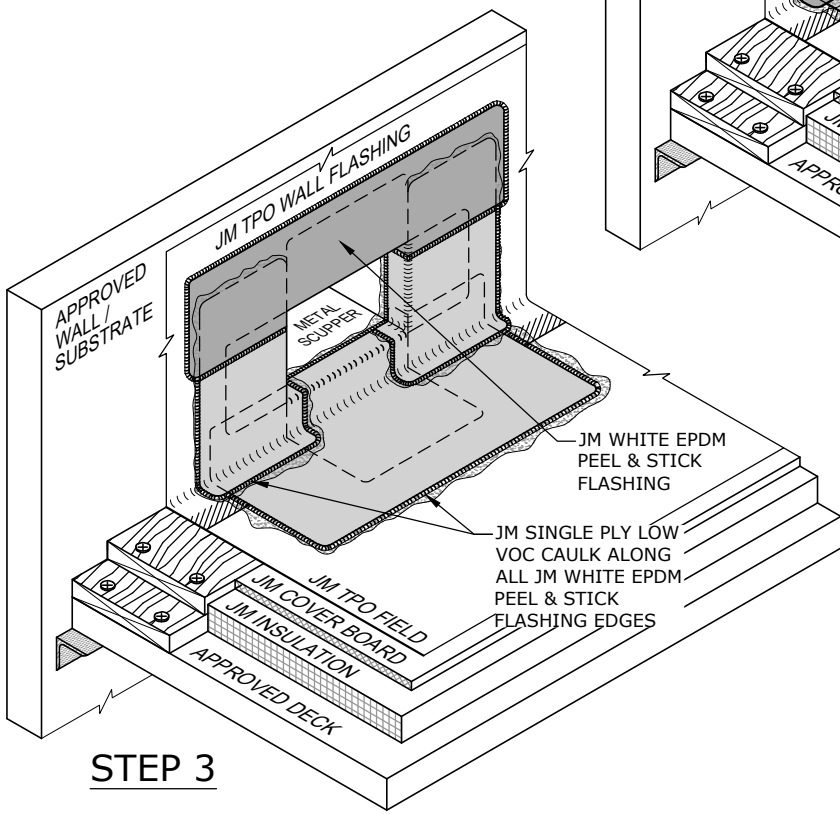

STEP 3

NOTES:

1. REFER TO JOHNS MANVILLE WEBSITE (www.jm.com) FOR MOST UP-TO-DATE INFORMATION.
2. PLEASE SEE SINGLE PLY FLASHING SPECIFICATIONS FOR A FULL DESCRIPTION OF INSTALLATION INSTRUCTIONS AND REQUIREMENTS WHICH ARE CONSIDERED A PART OF THIS DETAIL.
3. ANY CARPENTRY OR METAL WORK SHOULD BE DESIGNED AND CONSTRUCTED IN ACCORDANCE WITH LOCAL CODE REQUIREMENTS AND/OR PROJECT SPECIFICATIONS. THESE COMPONENTS SHOULD BE REVIEWED AND APPROVED BY A LICENSED DESIGN PROFESSIONAL.
4. SPREAD JM TPO MEMBRANE PRIMER OR JM SINGLE PLY MEMBRANE PRIMER (LOW VOC) BEYOND JM WHITE EPDM PEEL & STICK PRODUCTS. APPLY JM SINGLE PLY LOW VOC CAULK ALONG ALL MEMBRANE FLASHING EDGES
5. JM TPO MEMBRANE PRIMER OR JM SINGLE PLY MEMBRANE PRIMER (LOW VOC) MUST BE APPLIED ON ALL SURFACES COMING INTO CONTACT WITH JM WHITE EPDM PEEL & STICK PRODUCTS. ROLL ENTIRE MEMBRANE WITH HAND ROLLER UNDER PRESSURE.

DRAWING NO.
TWE-DV-06

**ALTERNATE OVERFLOW SCUPPER
WITH JM WHITE EPDM PEEL & STICK FLASHING**

DRAINS/VENTS

MEMBRANE TYPE:
TPO / JM WHITE EPDM

SCALE
N.T.S

ISSUE DATE
09-11-24

MAXIMUM GUARANTEE TERM:
20 YEAR

Johns Manville is a manufacturer of commercial roofing products and offers this general conceptual information to you as a courtesy for general educational purposes only. This complimentary assistance is not to be either used or relied upon by anyone as a substitute for professional engineering design and documentation required by any building code, contract, or applicable law. By accepting the general conceptual information, you agree it does not constitute any representations, endorsements of, or an assumption by Johns Manville of any duty or liability for either the adequacy of the design of a building, any of its components or the sufficiency of any construction.

